



AIRCHARGER®

HIGH-FLOW INTAKE KITS

NOT LEGAL FOR SALE OR USE ON ANY POLLUTION CONTROLLED MOTOR VEHICLE IN CALIFORNIA OR STATES ADOPTING CALIFORNIA EMISSION PROCEDURES.
See knfilters.com for CARB status on each part for a specific vehicle

INSTALLATION INSTRUCTIONS

63-3115
CHEVROLET / GMC / CADILLAC
2019-21 Blazer
2017-21 XT5 / Acadia
V6-3.6L

TOOLS NEEDED:

- flat blade screw driver
- 3mm allen key
- 4mm allen key
- t20 torx
- side cutters

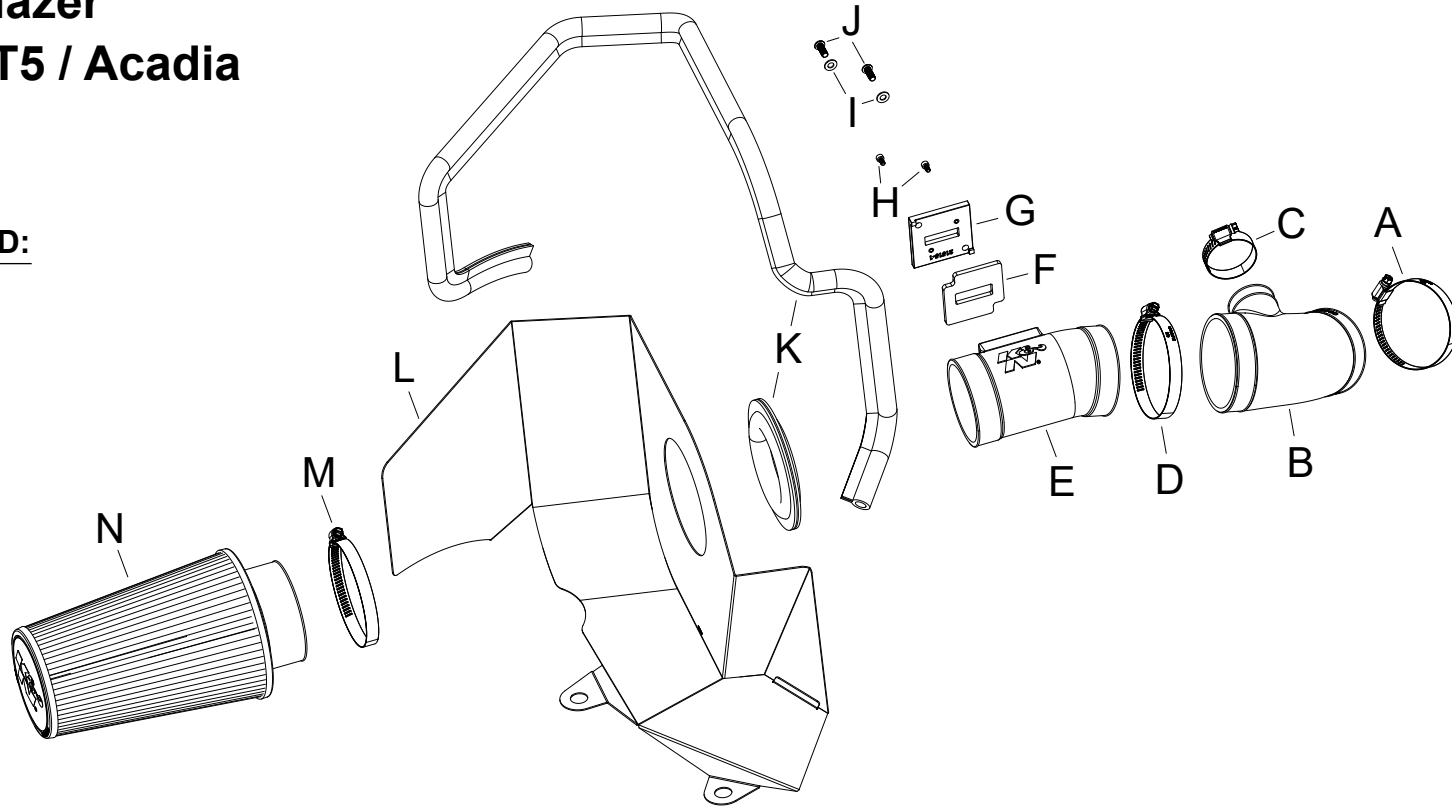

PARTS LIST:

Description	Qty.	Part #	Description	Qty.	Part #	Description	Qty.	Part #
A HOSE CLAMP #48	1	08601	F GASKET; 3/16" PORON	1	09069	K EDGE TRIM (75")	1	102460
B HOSE; 3"ID TO 3-1/2"ID, 35DEG	1	084109	G ADAPTOR; MAF SENSOR	1	21515-1	L HEAT SHIELD; MILD	1	07357
C HOSE CLAMP; #24	1	08460	H BOLT; M4 - 0.7 8MM, A/H CAP	2	07733	M HOSE CLAMP; #60	1	08624
D HOSE CLAMP #56	1	08620	I WASHER; 6MM FLAT, SS	2	08269	N 3-1/2"ID FLG,6"B,4-1/2"CR T,9"L	1	RC-3690
E TUBE; NL, XLHDPE	1	087454	J BOLT; M6 X 1.00 X 16MM, SS	2	07730			

If you need any assistance please call 1-800-858-3333 to speak with a representative in our Customer Service Center before returning the product.

NOTE: FAILURE TO FOLLOW INSTALLATION INSTRUCTIONS AND NOT USING THE PROVIDED HARDWARE MAY DAMAGE THE INTAKE TUBE, THROTTLE BODY AND ENGINE.

TO START:

1. Turn off the ignition and disconnect the negative battery cable.
NOTE: Disconnecting the negative battery cable erases pre-programmed electronic memories. Write down all memory settings before disconnecting the negative battery cable. Some radios will require an anti-theft code to be entered after the battery is reconnected. The anti-theft code is typically supplied with your owner's manual. In the event your vehicles anti-theft code cannot be recovered, contact an authorized dealership to obtain your vehicles anti-theft code.



2. Disconnect the mass air sensor electrical connection.



3. Pry loose the band clamp that secures the intake plenum tube to the intake hose and remove the clamp.



4. Loosen the two hose clamps that secure the factory intake hose. Remove the factory intake hose from the vehicle.



5. Pull up the factory air filter housing to dislodge it from the mounting grommets and then remove the housing from the vehicle.
NOTE: K&N Engineering, Inc., recommends that customers do not discard factory air intake.

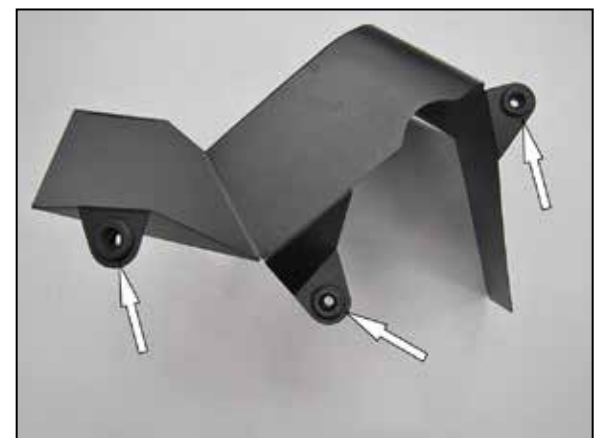

6. Remove the three mounting grommets from the factory air filter housing and install them into the K&N® heat shield as shown.

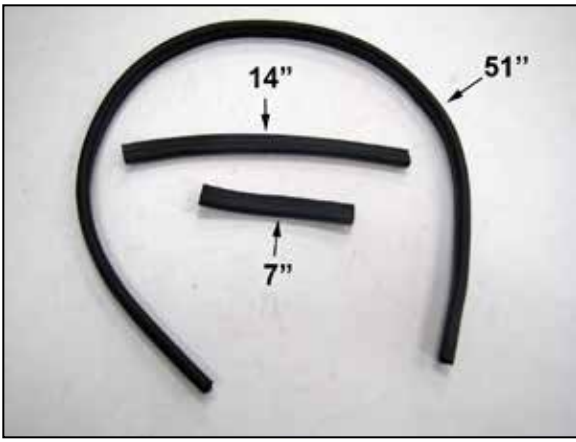

7. Cut the provided edge trim into sections of 51", 14" and 7" as shown.



8. Install the edge trim onto the heat shield as shown.



9. Install the heat shield assembly into the vehicle.



10. Install the provided coupler onto the throttle body and intake plenum. Secure with the provided hose clamps.



11. Remove the mass air sensor from the factory housing. Install the mass air sensor into the adapter provided and secure with the provided hardware. Install the provided gasket onto the adapter and then install the assembly into the K&N® intake tube and secure with the provided hardware. **NOTE: Be sure to install the sensor assembly in the direction shown, the open end of the sensor is to be towards the air filter.**



12. Install the K&N® intake tube assembly into the heat shield and coupler.



13. Install the air filter onto the intake tube, adjust the intake tube and filter for best fit and then secure the hose clamp.



14. Reconnect the mass air sensor electrical connection.



15. Reconnect the vehicle's negative battery cable. Double check to make sure everything is tight and properly positioned before starting the vehicle.

16. It will be necessary for all K&N® high flow intake systems to be checked periodically for realignment, clearance and tightening of all connections. Failure to follow the above instructions or proper maintenance may void warranty.

ROAD TESTING:

1. Start the engine with the transmission in neutral or park, and the parking brake engaged. Listen for air leaks or odd noises. For air leaks secure hoses and connections. For odd noises, find cause and repair before proceeding. This kit will function identically to the factory system except for being louder and much more responsive.

2. Test drive the vehicle. Listen for odd noises or rattles and fix as necessary.

3. If road test is fine, you can now enjoy the added power and performance from your kit.

4. K&N Engineering, Inc., requires cleaning the intake system's air filter element every 100,000 miles. When used in dusty or off-road environments, our filters will require cleaning more often. We recommend that you visually inspect your filter once every 25,000 miles to determine if the screen is still visible. When the screen is no longer visible some place on the filter element, it is time to clean it. To clean and re-oil, purchase our filter Recharger® service kit, part number 99-5050 or 99-5000 and follow the easy instructions.

NOT LEGAL FOR SALE OR USE ON ANY POLLUTION CONTROLLED MOTOR VEHICLE IN CALIFORNIA OR STATES ADOPTING CALIFORNIA EMISSION PROCEDURES.

See knfilters.com for CARB status on each part for a specific vehicle